

Description	: Flat Lithium Battery
Chemical system	: Lithium Manganese
Nominal voltage	: 3 Volts
Nominal capacity	: 50mAh
Dimensions	: Ø16mm x 1.6mm
Shelf life	: 10 years at room temperature
Average weight	: 1.1 grams
Operation temperature	: -20°C ~60°C
Storage temperature	: 20 ± 2°C

Cross References:

IEC	JIS	Panasonic	Varta
CR1616	CR1616	CR1616	CR1616

Discharge Characteristics

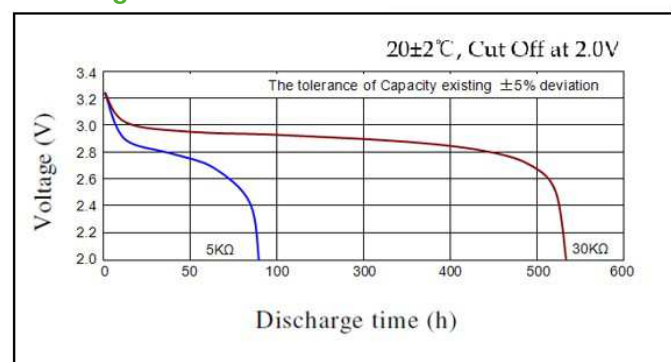

Pulse discharge characteristics

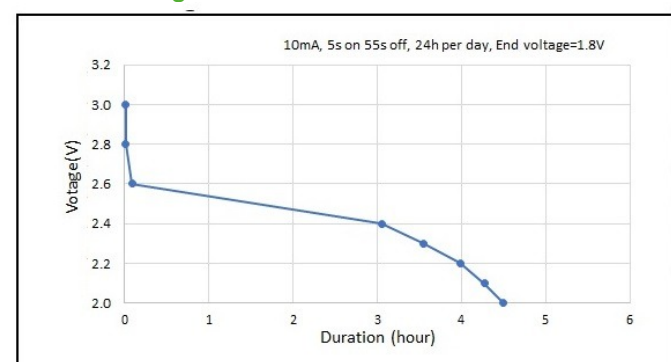

Model No.: **CR1616**

Ultra+
LITHIUM

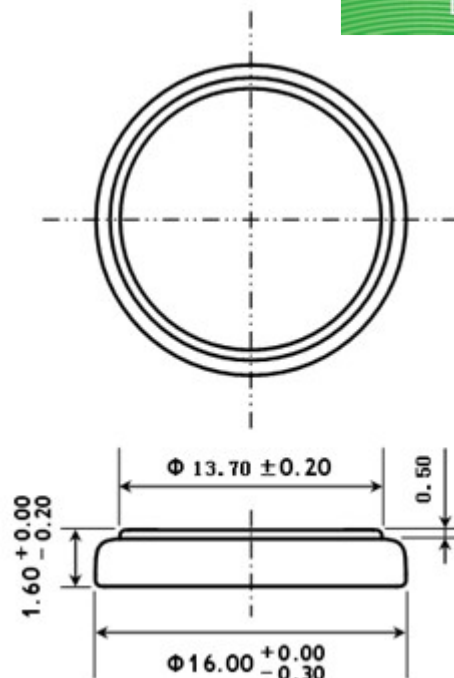

Dimension Drawing

The information (subject to change without prior notice) contained in this document is for reference only and should not be used as a basis for product guarantee or warranty. For applications other than those described here, please consult your nearest GP Sales and Marketing Office or Distributors.